

# High-Flow Stainless Tubes

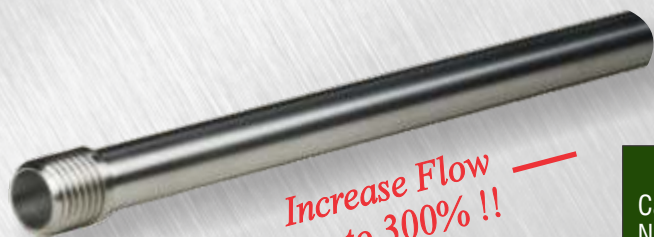

*Increase Flow  
up to 300% !!*

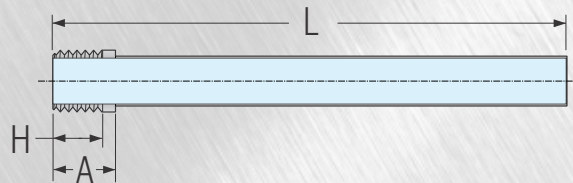

Catalog Number	Thread Size	Tube O.D.	Tube I.D.	Thread Length		Overall Length "L"				
				H	A	12"	18"	24"	36"	Lengths to 10 ft.
HF072T-	5-44	.072	.060	.125	.140	•	•	•	•	•
JHF072T-	10-32			.156	.203	•	•	•	•	•
HF093T-	5-44	.090	.076	.125	.140	•	•	•	•	•
JHF093T-	10-32			.156	.203	•	•	•	•	•
HF125T-	10-32	.125	.109	.156	.203	•	•	•	•	•
JHF125T-	1/4-28			.203	.255	•	•	•	•	•
HF187T-	1/4-28	.187	.167	.203	.255	•	•	•	•	•
JHF187T-	5/16-24			.235	.290	•	•	•	•	•
HF250T-	5/16-24	.250	.230	.235	.290	•	•	•	•	•
JHF250T-	3/8-24			.296	.359	•	•	•	•	•
HF312T-	3/8-24	.312	.288	.296	.359	•	•	•	•	•
JHF312T-	7/16-20			.359	.437	•	•	•	•	•
HF375T-	7/16-20	.365	.340	.359	.437	•	•	•	•	•
JHF375T-	1/2-20			.421	.500	•	•	•	•	•
HF437T-	1/2-20	.427	.397	.421	.500	•	•	•	•	•
JHF437T-	9/16-18			.421	.500	•	•	•	•	•
HF500T-	9/16-18	.500	.444	.421	.531	•	•	•	•	•
JHF500T-	5/8-18			.421	.531	•	•	•	•	•

STOCK ITEM

To order, specify Catalog Number and Overall Length. Example: HF250T-18

# R-Style High-Flow Tubes

- All stainless construction for high strength and durability.
- We stock over 150 sizes of thin wall stainless tube. (See adjacent page)
- We build stepped tube assemblies and custom threaded tubes to your print.

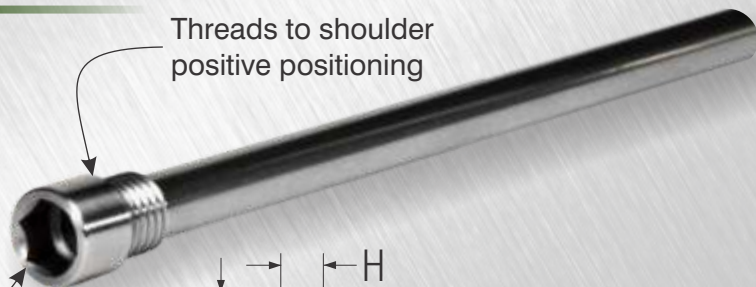

Threads to shoulder positive positioning

Hex wrench installation

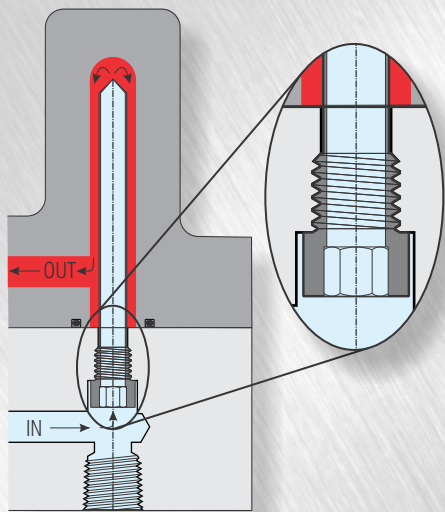
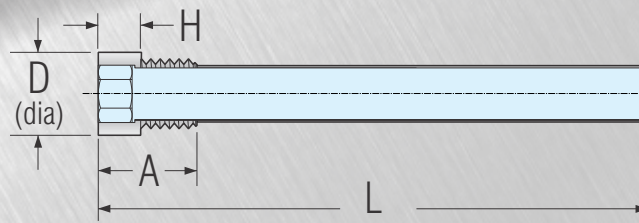

*Can install from alternate locations, even after plates are assembled, for easier maintenance, and quicker inspections.*

Catalog Number	Thread Size	Tube O.D.	Tube I.D.	Wrench Size	Head		Dia. D	Overall Length L			
					Height H	Length A		12"	18"	24"	36"
R072T-	5-44	.072	.060	1/8	.156	.312	.182	•	•	•	•
JR072T-	10-32			1/8	.187	.406	.245	•	•	•	•
R090T-	5-44	.090	.076	1/8	.156	.312	.182	•	•	•	•
JR090T-	10-32			1/8	.187	.406	.245	•	•	•	•
R125T-	10-32	.125	.109	5/32	.187	.406	.245	•	•	•	•
JR125T-	1/4-28			5/32	.187	.406	.307	•	•	•	•
R187T-	1/4-28	.187	.167	3/16	.250	.500	.307	•	•	•	•
JR187T-	5/16-24			1/4	.281	.562	.370	•	•	•	•
R250T-	5/16-24	.250	.230	1/4	.281	.562	.370	•	•	•	•
JR250T-	3/8-24			5/16	.312	.625	.495	•	•	•	•
R312T-	3/8-24	.312	.288	5/16	.312	.625	.495	•	•	•	•
JR312T-	1/2-20			3/8	.375	.750	.620	•	•	•	•

STOCK ITEM

To order, specify Catalog Number and Overall Length. Example: R250T-18

# Pipe Plug Style High-Flow Tubes

Coolant flows through flush seal pipe plug and high flow stainless tube.

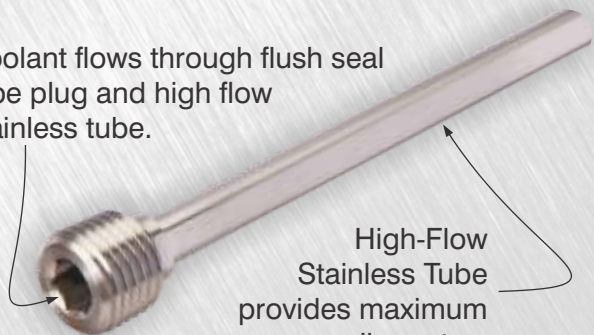

High-Flow Stainless Tube provides maximum cooling rates.

- All stainless steel construction provides high strength and reliable performance.
- Stainless flush-seal pipe plug standard. Other sizes and materials are available.

Catalog Number	Pipe Size (NPT)	Wrench Size	Tube O.D.	Tube I.D.	— Overall Length "L" —				
					12"	24"	36"	48"	Lengths to 10 ft.
PT16-072-	1/16	5/32	.072	.060	•	•	•	•	•
PT16-093-			.090	.076	•	•	•	•	•
PT16-109-			.109	.095	•	•	•	•	•
PT16-125-			.125	.109	•	•	•	•	•
PT16-187-			.187	.167	•	•	•	•	•
PT18-125-	1/8	3/16	.125	.109	•	•	•	•	•
PT18-187-			.187	.167	•	•	•	•	•
PT18-250-			1/4	.250	.230	•	•	•	•
PT14-187-	1/4	1/4	.187	.167	•	•	•	•	•
PT14-250-			.250	.230	•	•	•	•	•
PT14-312-			5/16	.312	.288	•	•	•	•
PT38-312-	3/8	5/16	.312	.288	•	•	•	•	•
PT38-375-			.365	.340	•	•	•	•	•
PT38-437-			3/8	.427	.397	•	•	•	•
PT12-375-	1/2	3/8	.365	.340	•	•	•	•	•
PT12-437-			.427	.397	•	•	•	•	•
PT12-500-			1/2	.500	.444	•	•	•	•
PT34-437-	3/4	9/16	.427	.397	•	•	•	•	•
PT34-500-			.500	.444	•	•	•	•	•
PT34-625-			.625	.569	•	•	•	•	•

STOCK ITEM

To order, specify Catalog Number & Overall Length. Example: PT14-250-12

# Custom High-Flow Tubes

- We can manufacture all types of cooling tubes from our extensive stock of high flow stainless tubing.
- Tubing is type 304 stainless steel, full hard.

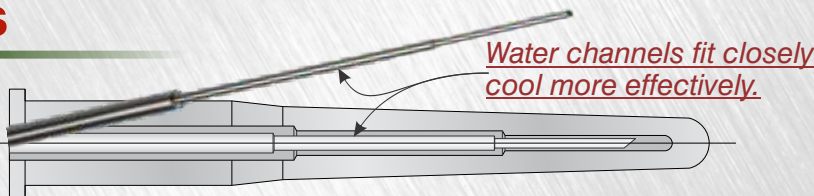

Gage Size	O.D.	I.D.
3RW	.259	.219
3TW	.259	.229
3XT	.259	.239
4RW	.238	.198
4TW	.238	.208
4XT	.238	.218
5RW	.219	.189
5TW	.219	.199
5XT	.219	.205
6RW	.203	.173
6TW	.203	.183
6X	.203	.189
7RW	.180	.150
7TW	.180	.160
7X	.180	.166
8RW	.165	.135
8TW	.165	.145

Gage Size	O.D.	I.D.
8XX	.165	.150
9RW	.148	.118
9TW	.148	.128
9XX	.148	.135
10RW	.134	.106
10TW	.134	.114
10XT	.134	.118
11RW	.120	.094
11TW	.120	.100
11X	.120	.106
12RW	.109	.085
12TW	.109	.091
12XT	.109	.095
13RW	.095	.071
13TW	.095	.077
13X	.095	.085
14RW	.083	.063

Gage Size	O.D.	I.D.
14TW	.083	.067
14XT	.083	.072
15RW	.072	.054
15TW	.072	.060
15XTS	.072	.063
16RW	.065	.047
16TW	.065	.053
16XT	.065	.055
17RW	.058	.042
17TW	.058	.048
17XT	.058	.050
18RW	.050	.033
18TW	.050	.038
18XT	.050	.042
19RW	.042	.027
19TW	.042	.032
19XT	.042	.035

Gage Size	O.D.	I.D.
20RW	.0355	.0235
20TW	.0355	.0255
20XT	.0355	.0275
21RW	.032	.020
21TW	.032	.023
21XT	.032	.025
22RW	.028	.016
22TW	.028	.020
22XTS	.028	.021
23RW	.025	.013
23TW	.025	.017
23XX	.025	.020
24RW	.022	.012
24TW	.022	.014
24XX	.022	.016
25RW	.020	.010
25TW	.020	.012

Gage Size	O.D.	I.D.
25XX	.020	.016
26RW	.018	.010
26TW	.018	.012
26XV	.018	.0135
27RW	.016	.008
27TW	.016	.010
27XV	.016	.0115
28RW	.014	.007
28TW	.014	.009
28XV	.014	.0105
29RW	.013	.007
30RW	.012	.006
31RW	.010	.005
32RW	.009	.004
33RW	.008	.004
34RW	.007	.003
35RW	.005	.002

# Standard Brass Tubes



- Tubes 18" and longer have both ends threaded.
- Half-hard temper for reliable performance.
- Also available in Stainless Steel.
- Bulk tube available.

Catalog Number	Thread Size	Thread Length	Tube O.D.	Tube I.D.	— Overall Length "L" —			
					12"	18"	24"	36"
125T-	5-44	3/16	.125	.061	•	•	•	•
187T-	10-32	3/16	.187	.123	•	•	•	•
250T-	1/4-28	1/4	.250	.170	•	•	•	•
312T-	5/16-24	5/16	.312	.210	•	•	•	•
375T-	3/8-24	3/8	.375	.273	•	•	•	•
437T-	7/16-20	7/16	.437	.307	•	•	•	•
625T-	5/8-18	5/8	.625	.495	•	•	•	•

To order, specify Catalog Number and Overall Length. Example: 250T-18

STOCK ITEM