

# Couplers + PLUS

**Maximum Flow**  
**Twist-Lock Sleeve**  
**Safe & Secure**

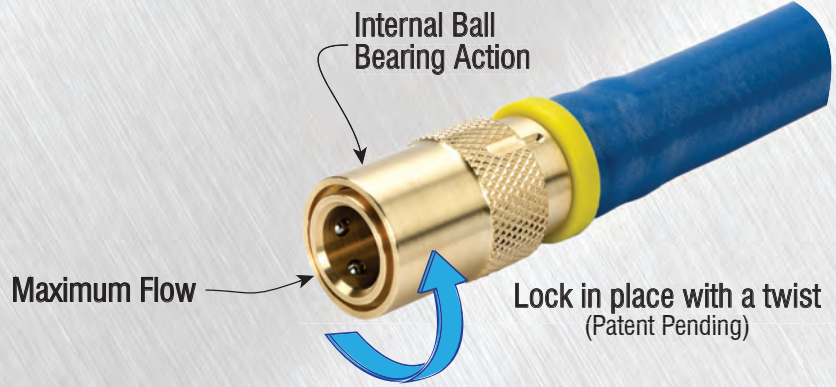

## For Push-Lok Hose

- **No hose clamps required** when used with Push-Lok Hose



- Straight thru design for maximum flow rates

- Sleeve lock provides safety



- All brass and stainless steel construction

- Compatible with all mold connection systems



### 200 Series (1/4" Hole)

Catalog Number	Hose I.D.	Stock Item
CM-204-PL	1/4	•
CM-205-PL	5/16	•
CM-206-PL	3/8	•

Catalog Number	Hose I.D.	Stock Item
CM-224-PL	1/4	•
CM-225-PL	5/16	•
CM-226-PL	3/8	•

Catalog Number	Hose I.D.	Stock Item
CM-214-PL	1/4	•
CM-215-PL	5/16	•
CM-216-PL	3/8	•

### 300 Series (3/8" Hole)

Catalog Number	Hose I.D.	Stock Item
CM-306-PL	3/8	•
CM-308-PL	1/2	•

Catalog Number	Hose I.D.	Stock Item
CM-326-PL	3/8	•
CM-328-PL	1/2	•

Catalog Number	Hose I.D.	Stock Item
CM-316-PL	3/8	•
CM-318-PL	1/2	•

### 500 Series (1/2" Hole)

Catalog Number	Hose I.D.	Stock Item
CM-504-PL	1/2	•
CM-506-PL	3/4	•

Catalog Number	Hose I.D.	Stock Item
CM-524-PL	1/2	•
CM-526-PL	3/4	•

Catalog Number	Hose I.D.	Stock Item
CM-514-PL	1/2	•
CM-516-PL	3/4	•

## With Standard Barbs

- Use hose clamps with these couplers



- Straight thru design for maximum flow rates

- Sleeve lock provides safety



- All brass and stainless steel construction

- Compatible with all mold connection systems



### 200 Series (1/4" Hole)

Catalog Number	Hose I.D.	Stock Item
CM-204	1/4	•
CM-205	5/16	•
CM-206	3/8	•

Catalog Number	Hose I.D.	Stock Item
CM-224	1/4	•
CM-225	5/16	•
CM-226	3/8	•

Catalog Number	Hose I.D.	Stock Item
CM-214	1/4	•
CM-215	5/16	•
CM-216	3/8	•

### 300 Series (3/8" Hole)

Catalog Number	Hose I.D.	Stock Item
CM-306	3/8	•
CM-308	1/2	•

Catalog Number	Hose I.D.	Stock Item
CM-326	3/8	•
CM-328	1/2	•

Catalog Number	Hose I.D.	Stock Item
CM-316	3/8	•
CM-318	1/2	•

### 500 Series (1/2" Hole)

Catalog Number	Hose I.D.	Stock Item
CM-504	1/2	•
CM-506	3/4	•

Catalog Number	Hose I.D.	Stock Item
CM-524	1/2	•
CM-526	3/4	•

Catalog Number	Hose I.D.	Stock Item
CM-514	1/2	•
CM-516	3/4	•

## Bodies Only

- Flow-thru type
- Select pipe thread to suit your application



200 Series (1/4" Hole)		
Catalog Number	Thread Size	Stock Item
CMB-200	1/8	•
CMB-200-1/4	1/4	•

300 Series (3/8" Hole)		
Catalog Number	Thread Size	Stock Item
CMB-300	1/4	•
CMB-300-3/8	3/8	•

500 Series (1/2" Hole)		
Catalog Number	Thread Size	Stock Item
CMB-500	1/2	•

COUPLERS

# Combination Hose Inserts

Eliminates multiple fittings and assembly. Put a Combination Hose Insert on one end of a hose, and a Coupler on the other. Hoses may then be snapped together in series.

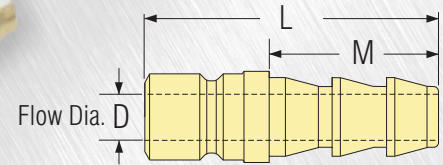

- All flow diameters maximized to reduce restrictions.
- For use with Push-Lok or standard hose.

200 Series (1/4" Hole)					
Catalog Number	Hose I.D.	D	M	L	Stock Item
200-4	1/4	3/16	7/8	1 3/8	•
200-5	5/16	1/4	7/8	1 3/8	•
200-6	3/8	1/4	1 1/16	1 9/16	•
200-8	1/2	1/4	1 1/16	1 9/16	•

300 Series (3/8" Hole)					
Catalog Number	Hose I.D.	D	M	L	Stock Item
300-4	1/4	3/16	7/8	1 13/16	•
300-5	5/16	1/4	7/8	1 13/16	•
300-6	3/8	9/32	1 1/16	1 13/16	•
300-8	1/2	1 1/32	1 1/16	1 13/16	•

500 Series (1/2" Hole)					
Catalog Number	Hose I.D.	D	M	L	Stock Item
500-8	1/2	13/32	1 1/16	2	•
500-12	3/4	9/16	1 1/2	2 1/2	•

# Stop Plugs

- Stops coolant flow on hoses with flow-thru couplers.
- Prevents accidents by plugging unused hoses and manifold ports.
- Keeps couplers and seals clean when not in use.



200 Series (1/4" Hole)		
Catalog Number	Fits Socket Series No.	Stock Item
CP-200	200 (1/4" Hole)	•

300 Series (3/8" Hole)		
Catalog Number	Fits Socket Series No.	Stock Item
CP-300	300 (3/8" Hole)	•

500 Series (1/2" Hole)		
Catalog Number	Fits Socket Series No.	Stock Item
CP-500	500 (1/2" Hole)	•

# Connector Plugs

NPT or BSPT threads in stock

- MALE TYPE (brass)



NPT

BSPT

200 Series (1/4" Hole)				
Catalog Number	Pipe Thread	Flow Dia.	Stock Item	
250	1/16	3/16	•	
251	1/8	1/4	•	
252	1/4	1/4	•	
253	3/8	1/4	•	
251-BSP	1/8	1/4	•	
252-BSP	1/4	1/4	•	

## 300 Series (3/8" Hole)

Catalog Number	Pipe Thread	Flow Dia.	Stock Item
351	1/8	1/4	•
352	1/4	3/8	•
353	3/8	3/8	•
354	1/2	3/8	•
351-BSP	1/8	1/4	•
352-BSP	1/4	3/8	•
353-BSP	3/8	3/8	•

## 500 Series (1/2" Hole)

Catalog Number	Pipe Thread	Flow Dia.	Stock Item
552	1/4	3/8	•
553	3/8	1/2	•
554	1/2	5/8	•
556	3/4	5/8	•
553-BSP	3/8	1/2	•
554-BSP	1/2	5/8	•

- FEMALE TYPE (zinc plated steel)



Catalog Number	Pipe Thread	Flow Dia.	Stock Item
250-F	Available in brass below.		
251-F	1/8	1/4	•
252-F	1/4	1/4	•
253-F	3/8	1/4	•

Catalog Number	Pipe Thread	Flow Dia.	Stock Item
351-F	Available in brass below.		
352-F	1/4	3/8	•
353-F	3/8	3/8	•
354-F	1/2	3/8	•

Catalog Number	Pipe Thread	Flow Dia.	Stock Item
Available in brass below.			

- FEMALE TYPE (brass)



NPT

BSPT

Catalog Number	Pipe Thread	Flow Dia.	Stock Item
250-FB	1/16	1/4	•
251-FB	1/8	1/4	•
252-FB	1/4	1/4	•
253-FB	3/8	1/4	•
251-FB-BSP	1/8	1/4	•
252-FB-BSP	1/4	1/4	•

Catalog Number	Pipe Thread	Flow Dia.	Stock Item
351-FB	1/8	1 1/32	•
352-FB	1/4	3/8	•
353-FB	3/8	3/8	•
354-FB	1/2	3/8	•
351-FB-BSP	1/8	1 1/32	•
352-FB-BSP	1/4	3/8	•
353-FB-BSP	3/8	3/8	•

Catalog Number	Pipe Thread	Flow Dia.	Stock Item
551-FB	1/8	1 1/32	•
552-FB	1/4	7/16	•
553-FB	3/8	9/16	•
554-FB	1/2	5/8	•
553-FB-BSP	3/8	9/16	•
554-FB-BSP	1/2	5/8	•

# Brass Extension Plugs

- All Custom Mold Extension Plugs have tapered pipe threads.

*Standard pipe thread systems require tapered external threads to seal in taper threaded holes*

- In stock from 1/16" thru 1/2" pipe, including BSPT pipe sizes.

When length adjustments are required, simply cut to length. The straight, pre-cut threads on shank make re-tapering easy.

- Available in brass and stainless steel.
- NPT and BSPT available from stock.

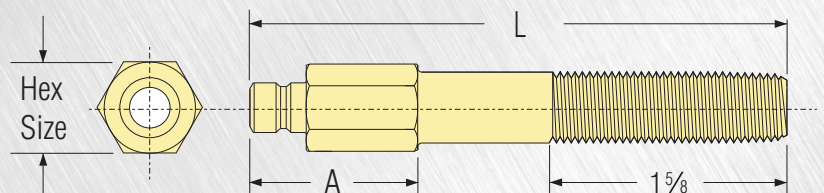
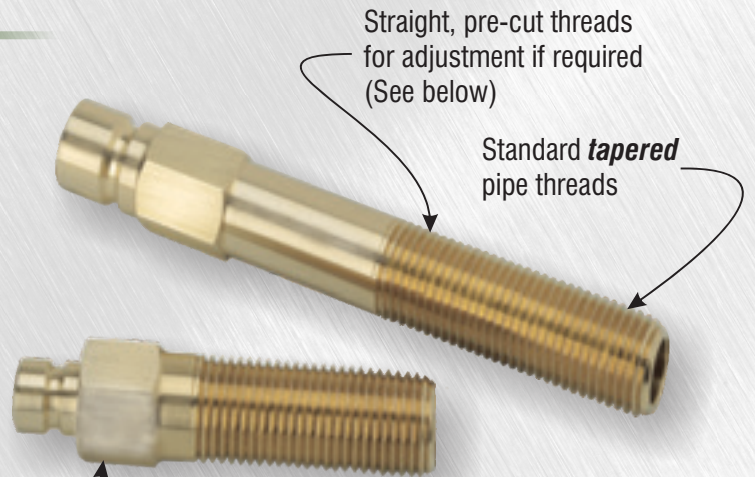

## Length Adjustments

1. When special length adjustments are required, simply cut piece to length and chamfer end.

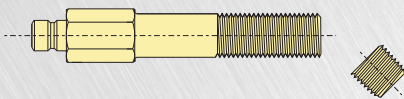

2. Turn into standard pipe threading die to re-taper threads.

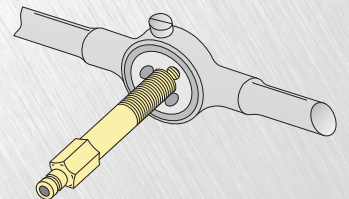

## Exact Length Extension Plugs

- Same quality extension plugs as above, threaded to any required length.
- Simply specify part number along with length required. eg: 352 x 3.187
- Available with pre-applied sealant.
- Order any quantity, same day shipment.



## BSPT & Stainless Extension Plugs

- BSP brass Extension Plugs IN STOCK.
- Many Stainless Extension Plugs IN STOCK.
- Available with pre-applied sealant.
- Order any quantity.



## 200 Series (1/4" Hole)

1/4" HOLE  
Actual Size

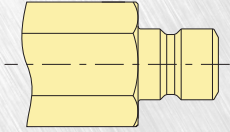

Catalog Number	L	Pipe Size	Hex Size	A	Stock Item
----------------	---	-----------	----------	---	------------

### 1/16" Pipe Extensions

250 x 2½	2½	1/16	3/8	11/16	•
250 x 4	4	1/16	3/8	13/16	•
250 x 5½	5½	1/16	3/8	13/16	•
250 x 7	7	1/16	3/8	13/16	•

### 1/8" Pipe Extensions

251 x 2½	2½	1/8	7/16	11/16	•
251 x 4	4	1/8	7/16	1	•
251 x 5½	5½	1/8	7/16	1	•
251 x 7	7	1/8	7/16	1	•
251 x 8½	8½	1/8	7/16	1	•
251 x 10	10	1/8	7/16	1	•
251 x 11½	11½	1/8	7/16	1	•
251 x 13	13	1/8	7/16	1	•

### 1/4" Pipe Extensions

252 x 2½	2½	1/4	9/16	7/8	•
252 x 4	4	1/4	9/16	11/4	•
252 x 5½	5½	1/4	9/16	11/4	•
252 x 7	7	1/4	9/16	11/4	•
252 x 8½	8½	1/4	9/16	11/4	•
252 x 10	10	1/4	9/16	11/4	•
252 x 11½	11½	1/4	9/16	11/4	•
252 x 13	13	1/4	9/16	11/4	•

### 3/8" Pipe Extensions

253 x 2½	2½	3/8	11/16	1	•
253 x 4	4	3/8	11/16	11/4	•
253 x 5½	5½	3/8	11/16	11/4	•
253 x 7	7	3/8	11/16	11/4	•
253 x 8½	8½	3/8	11/16	11/4	•
253 x 10	10	3/8	11/16	11/4	•
253 x 11½	11½	3/8	11/16	11/4	•
253 x 13	13	3/8	11/16	11/4	•

### 1/2" Pipe Extensions

Available on request

## 300 Series (3/8" Hole)

3/8" HOLE  
Actual Size

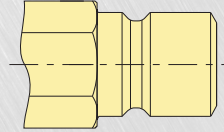

Catalog Number	L	Pipe Size	Hex Size	A	Stock Item
----------------	---	-----------	----------	---	------------

### 1/16" Pipe Extensions

350 x 2½	2½	1/16	9/16	7/8	•
350 x 4	4	1/16	9/16	1	•
350 x 5½	5½	1/16	9/16	1	•
350 x 7	7	1/16	9/16	1	•

### 1/8" Pipe Extensions

351 x 2½	2½	1/8	9/16	7/8	•
351 x 4	4	1/8	9/16	1	•
351 x 5½	5½	1/8	9/16	1	•
351 x 7	7	1/8	9/16	1	•
351 x 8½	8½	1/8	9/16	1	•
351 x 10	10	1/8	9/16	1	•
351 x 11½	11½	1/8	9/16	1	•
351 x 13	13	1/8	9/16	1	•

### 1/4" Pipe Extensions

352 x 2½	2½	1/4	9/16	7/8	•
352 x 4	4	1/4	9/16	11/4	•
352 x 5½	5½	1/4	9/16	11/4	•
352 x 7	7	1/4	9/16	11/4	•
352 x 8½	8½	1/4	9/16	11/4	•
352 x 10	10	1/4	9/16	11/4	•
352 x 11½	11½	1/4	9/16	11/4	•
352 x 13	13	1/4	9/16	11/4	•

### 3/8" Pipe Extensions

353 x 2½	2½	3/8	11/16	1	•
353 x 4	4	3/8	11/16	11/4	•
353 x 5½	5½	3/8	11/16	11/4	•
353 x 7	7	3/8	11/16	11/4	•
353 x 8½	8½	3/8	11/16	11/4	•
353 x 10	10	3/8	11/16	11/4	•
353 x 11½	11½	3/8	11/16	11/4	•
353 x 13	13	3/8	11/16	11/4	•

### 1/2" Pipe Extensions

354 x 2½	2½	1/2	7/8	11/8	•
354 x 4	4	1/2	7/8	11/2	•
354 x 5½	5½	1/2	7/8	11/2	•
354 x 7	7	1/2	7/8	11/2	•
354 x 8½	8½	1/2	7/8	11/2	•
354 x 10	10	1/2	7/8	11/2	•
354 x 11½	11½	1/2	7/8	11/2	•
354 x 13	13	1/2	7/8	11/2	•

## 500 Series (1/2" Hole)

1/2" HOLE  
Actual Size

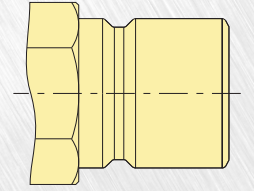

Catalog Number	L	Pipe Size	Hex Size	A	Stock Item
----------------	---	-----------	----------	---	------------

### 1/16" Pipe Extensions

Available on request

### 1/8" Pipe Extensions

Available on request

### 1/4" Pipe Extensions

Available on request

### 3/8" Pipe Extensions

553 x 2½	2½	3/8	13/16	1 1/8	•
553 x 4	4	3/8	13/16	1 3/8	•
553 x 5½	5½	3/8	13/16	1 3/8	•
553 x 7	7	3/8	13/16	1 3/8	•
553 x 8½	8½	3/8	13/16	1 3/8	•
553 x 10	10	3/8	13/16	1 3/8	•
553 x 11½	11½	3/8	13/16	1 3/8	•
553 x 13	13	3/8	13/16	1 3/8	•

### 1/2" Pipe Extensions

554 x 2½	2½	1/2	7/8	1 1/8	•
554 x 4	4	1/2	7/8	1 1/2	•
554 x 5½	5½	1/2	7/8	1 1/2	•
554 x 7	7	1/2	7/8	1 1/2	•
554 x 8½	8½	1/2	7/8	1 1/2	•
554 x 10	10	1/2	7/8	1 1/2	•
554 x 11½	11½	1/2	7/8	1 1/2	•
554 x 13	13	1/2	7/8	1 1/2	•

Custom Mold Brass Extension Plugs are available cut and re-threaded to any exact length for an additional charge of \$.50 ea. Order 100 or more pieces of one length, and exact length adjustment is free.

# Quick-Coupler Type Water Jumpers

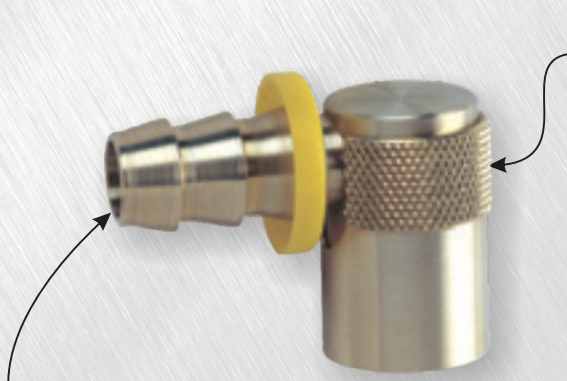

Coupler sleeve twists to lock, preventing accidental disconnect.

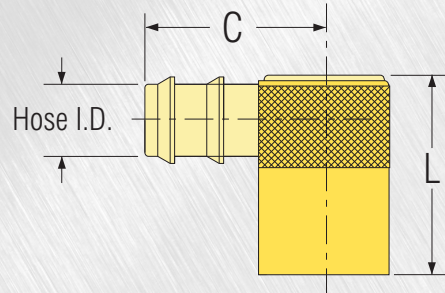

For use with Push-Lok hose, no hose clamps are required.

Catalog Number	Hose I.D.	Fits Plug Series No.	L	C	M	A	Stock Item
WJ200-4	1/4	200	1	1 1/4	3/8	5/8	•
WJ200-6	3/8						•
WJ300-6	3/8	300	1 7/16	1 9/16	1/2	7/8	•
WJ300-8	1/2						•
WJ500-8	1/2	500	2 1/8	2	7/8	1 5/16	•
WJ500-12	3/4						•

## Oversized and unrestricted flow path maintains *full flow rate* of hose used.

- Compact design neatly and safely holds cooling lines close to the mold surface.
- Exclusive Locking Sleeve prevents accidental disconnect and ensures proper installation.
- Unlimited installation options. Fits around obstacles, and installs in compact spaces.
- Viton Seals provide for temps up to 400°F.
- All brass and stainless steel construction.
- Compatible with all major mold connection systems.

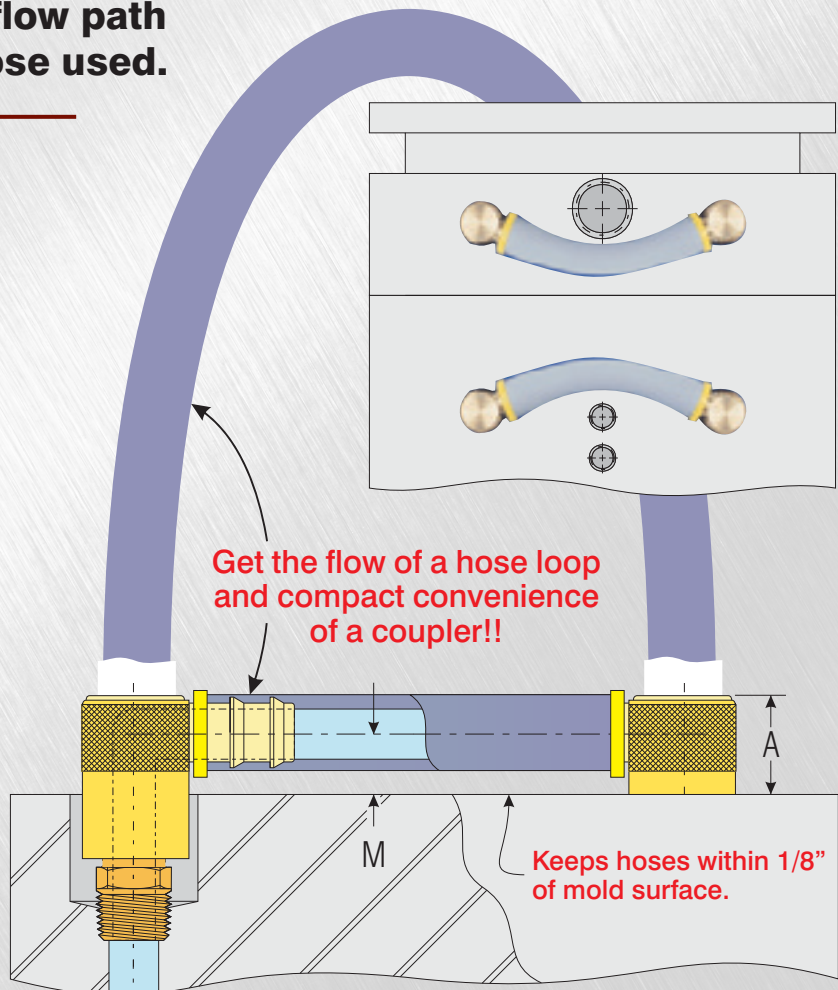

WATER JUMPERS

# Swivel Type Water Jumpers

- Can be fully recessed to prevent accidental disconnect or damage.
- Swivel body allows for installation in tight spaces.
- Eliminate crimped hoses and setup errors.
- Viton O-ring seals.
- All brass construction
- Easy hex key installation.
- Custom Length Water Jumpers available.

Heavy duty hex key socket allows maximum torque and positive removal.

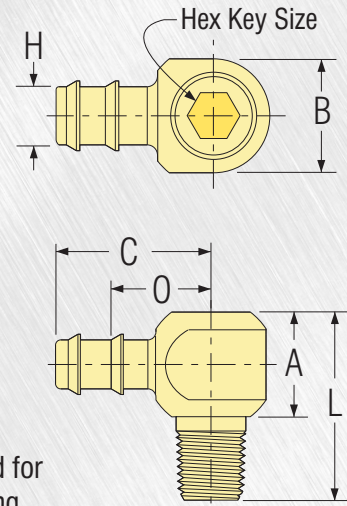
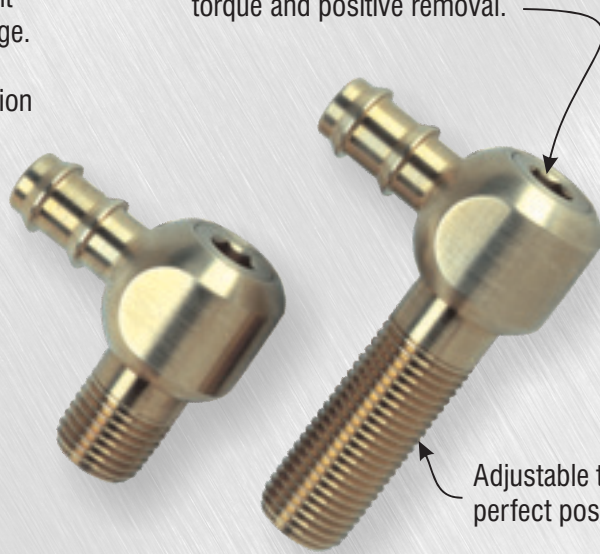

Catalog Number	Hose I.D. Size H	Pipe Size NPT	L	Hex Key Size	A	C	O	B	For Recessed Installation		Stock Item
									Min. Slot Width	Min. Slot Depth	
WJ18-S	5/16	1/8	1 3/16	3/16	1 1/16	1	5/8	.660	1 1/16	1	•
WJ18-M			2								•
WJ18-L			3 1/2								•
WJ14-S	3/8	1/4	1 7/16	1/4	1 3/16	25/32	.840	7/8	1 3/16	•	
WJ14-M			2 3/8							•	
WJ14-L			3 7/8							•	
WJ38-S	1/2	3/8	1 5/8	5/16	1	1 3/8	1 5/16	.980	1	1 3/8	•
WJ38-M			2 5/8								•
WJ38-L			4 1/8								•
WJ50-S50	1/2	1/2	2	3/8	1 1/8	1 1/2	1 1/8	1.235	1 1/4	1 9/16	•
WJ50-M50			3								•
WJ50-L50			4 1/2								•
WJ50-S	3/4	1/2	2	3/8	1 1/8	1 1/2	1 1/8	1.235	1 1/4	1 9/16	•
WJ50-M			3								•
WJ50-L			4 1/2								•

Flow Data

